



Elderfield & Hall, Inc.,

www.kooltools.com

10901 McBride Lane, Knoxville TN, 37932.

Phone: 865.671.7682. Fax: 865.671.7686.

Email: bob@kooltools.com

Kama Bandsaw AD 105S

110 Volt, Single Phase
2 ¼ HP Portable Benchttop Bandsaw
For Accurate Cuts Up to 4".



Parts diagram:

- Parts Diagram
- Accessories & Spare Parts

KAMA

AD 105 S

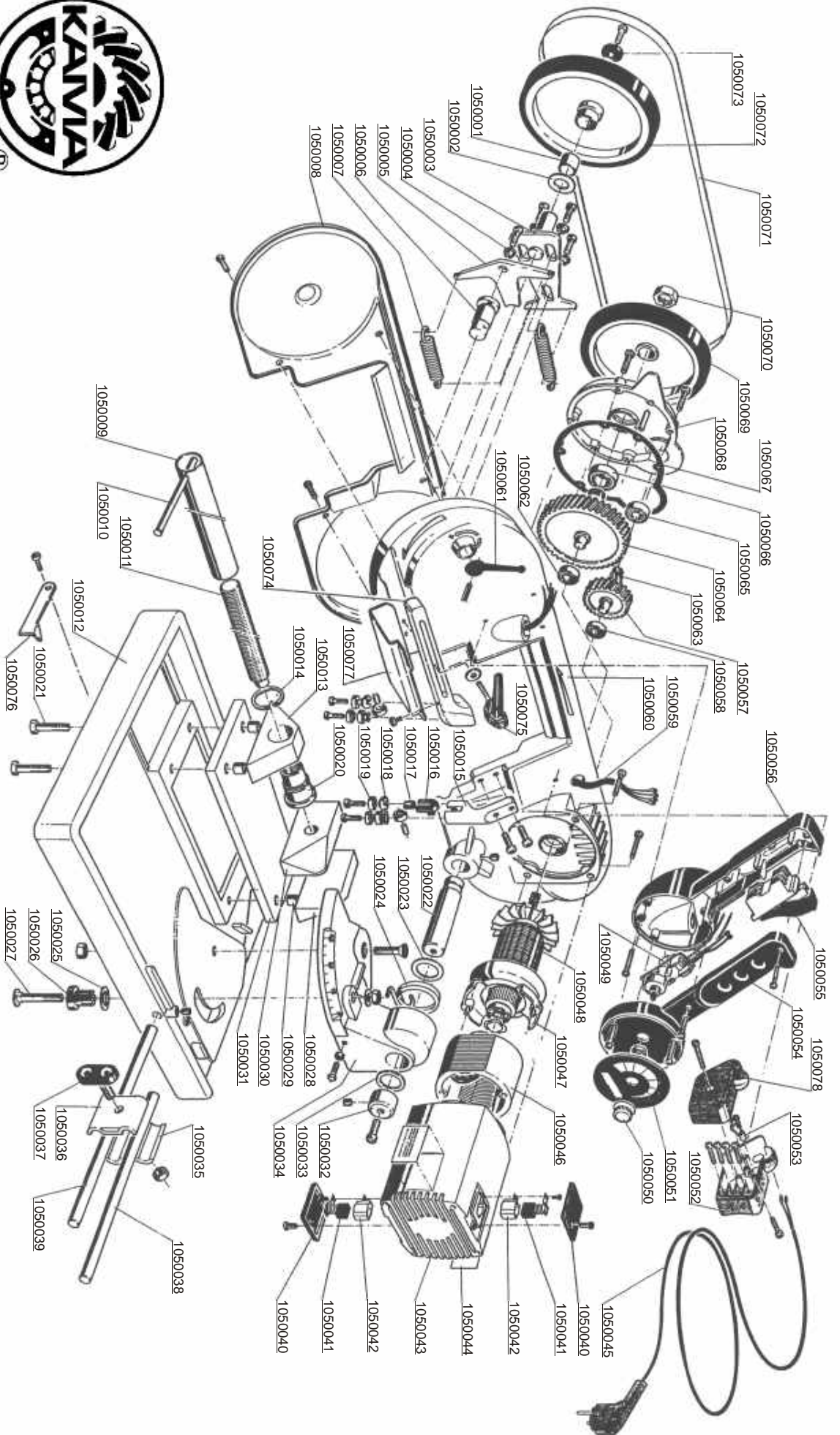

Accessories and Spare parts:

Part #	Description	Part #	Description
1050001	Ferrule	1050040	Brush Cap
1050002	Nylon Washer	1050041	Brush
1050003	Slide	1050042	Brush Holder
1050004	Special Ferrule	1050043	Motor Body
1050005	Spring Holder	1050044	Plate
1050006	Eccentric Pin	1050045	Cable with Plug
1050007	Spring	1050046	Stator
1050008	Crankcase	1050047	Air Conducting Ring
1050009	Screw Protection	1050048	Armature
1050010	Lever	1050049	Electronic Speed Regulator
1050011	Endless Screw	1050050	Knob
1050012	Base	1050051	Plate
1050013	Nut-Holder	1050052	Terminal Board
1050014	Snapping	1050053	Cable Holder
1050015	Fixed Blade Guide	1050054	Front Handle
1050016	Not in Use	1050055	Switch
1050017	Not in Use	1050056	Rear Handle
1050018	Bearing	1050057	Secondary Gear
1050019	Bearing	1050058	Bearing
1050020	Nut	1050059	Small Cable
1050021	Hexagonal Screw	1050060	Head Body
1050022	Small Shaft	1050061	Lever
1050023	Nylon Washer	1050062	Bearing
1050024	Spring	1050063	Intermediate Gear
1050025	Iron Washer	1050064	Final Gear w/ Drive Shaft
1050026	Pawl	1050065	Bearing
1050027	Special Screw	1050066	Bearing
1050028	Rear Jaw	1050067	Gasket
1050029	Ferrule	1050068	Cap
1050030	Sliding Jaw	1050069	Driving Pulley
1050031	Small Base	1050070	Special Nut
1050032	Special Washer	1050071	Blade (See List of Blades)
1050033	Nylon Washer	1050072	Driven Pulley
1050034	Turning Casing	1050073	Special Washer
1050035	Rear Hanger	1050074	Sliding Blade-Guide
1050036	Front Hanger	1050075	Swinging Lever
1050037	Knob	1050076	Locking Lever
1050038	Stopper Bar	1050077	Small Crankcase
1050039	Fixed Bar	1050078	Terminal Board Cap

LIST OF BLADES: (Packs of 10)

Part #	Size	Description
1050071610	44 - 7/8" x .025 x 1/2"	6-10 TPI BI-Metal Blade
1050071812	44 - 7/8" x .025 x 1/2"	8-12 TPI BI-Metal Blade (furnished with machine)
1050071014	44 - 7/8" x .025 x 1/2"	10-14 TPI BI-Metal Blade
1050071018	44 - 7/8" x .025 x 1/2"	18 TPI BI-Metal Blade
1050071DIA	44 - 7/8" x .025 x 1/2"	Diamond